

# Voice control

## PRINCIPLE OF OPERATION

Voice control enables operation of the audio and telephone systems without the need to divert your attention from the road ahead in order to change settings, or receive feedback from the system.

Whenever you issue one of the defined commands with the system active, the voice control system converts your command into a control signal for the audio or telephone system. Your inputs take the form of dialogues or commands. You are guided through these dialogues by announcements or questions.

Please familiarise yourself with the functions of the audio and telephone systems before using voice control.

## USING VOICE CONTROL

The voice recognition system includes a hands-free microphone mounted in the roof of your vehicle. There are a few points to observe to ensure that the system understands your commands:

- Speak continuously and at normal volume, avoiding unnatural emphasis and pauses between words.
- Do not speak while the voice recognition system is giving an output. The voice system displays **LISTENING** on the message centre, and gives a beep when it is waiting for a voice command.
- It is possible that noise from inside or outside the vehicle could affect commands. Keep the doors, windows, and sunroof closed. Reducing Climate control to a minimum while you are speaking will also help.

- If a command is not heard, or is misunderstood, the voice system responds with >Sorry<, >Command not recognised< or >No speech detected<. If this happens, repeat the command.
- Avoid causing background noise in the vehicle while you are speaking, and ask your passengers not to talk while you are issuing voice commands.
- The hands-free microphone is positioned to pick up the driver's voice.

## Activating the system



E82207

To activate voice control:

- Briefly pull the control (the audio will mute). A tone will be heard, and **LISTENING** will be displayed on the main message centre to indicate that the system is waiting for a voice command.

**Note:** It is only necessary to operate the control at the beginning of each voice session.

# Voice control

## Defined voice commands

The voice control system understands predefined commands which need to be quoted word for word.

An audio guide of voice commands is available. To activate the guide, pull the control briefly and give one of the following commands:

- **Voice help** - to list all commands.
- **Radio help** - to list Radio commands.
- **CD help** - to list CD commands.
- **Navigation help** - to list Navigation commands. Please refer to the Navigation Handbook for operating instructions.
- **Notepad Help** - to list Notepad commands. Please refer to the Owner's Handbook for operating instructions.

## Interrupting voice control

A command can be interrupted by saying the word Cancel or by pressing the control until the system responds by saying >Command cancelled<.

If you receive a telephone call (or Navigation route guidance instruction/TA announcement) while conducting a dialogue, the dialogue is interrupted.

## Command not recognised

If a command is not recognised, the system responds with:

>Sorry<, >Command not recognised<.

## Voice settings

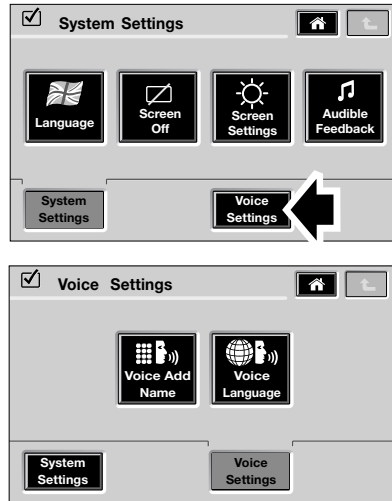

E91650

From the System Settings menu, touch the **Voice Settings** icon.

# Voice control

## Voice language

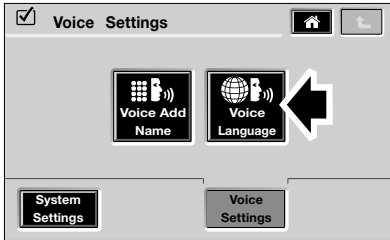

E91651

From the Voice Settings screen, touch the **Voice Language** icon.

It should be noted that the Voice Language icon is only available with the extended voice option and not with basic voice.

Touch the up and down arrows to scroll through the list of available languages.

Select the required language by touching the relevant icon.

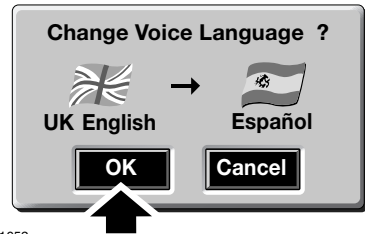

E91652

Touch the button icon next to the language you wish to use. A pop-up menu will appear indicating the current language, the new language and the option to cancel or accept the change.

Once your language choice has been made and you have pressed the **OK** icon, the main settings screen will be displayed.

# Voice control

---

## AUDIO UNIT COMMANDS

### Starting a dialogue

Hold the control until the tone is heard. Any audio sources in the vehicle are muted.

### Radio stations

Frequencies are said as in the following examples:

- **Radio Tune five forty AM, or Radio Tune five forty (540).**
- **Radio Tune nine hundred (900).**
- **Radio Tune fourteen forty (1440).**
- **Radio Tune fifteen oh three AM (1503).**
- **Radio Tune thirteen fifty AM (1350).**
- **Radio Tune ten eighty (1080).**
- **Radio Tune eighty seven point nine FM or Radio Tune eighty seven point nine (87.9).**
- **Radio Tune ninety point zero or Radio Tune ninety (90.0).**
- **Radio Tune one oh one point one FM (101.1).**

**Note:** The word **Select** can be used in place of the word **Tune** if preferred.

| Command                                       | System response        | Message centre display |
|---|------------------------|------------------------|
| "Radio play"                                  | >Radio play<           | <b>RADIO PLAY</b>      |
| "Radio tune eighty nine point nine FM (89.9)" | >Radio tune 89.9 FM<   | <b>89.9 FM</b>         |
| "Radio tune" <nametag>                        | >Radio tune <nametag>< | <b>Radio Tune</b>      |

# Voice control

---

## Nametags

Nametags are a unique name or phrase of your choice which can be used to recall a radio station. The nametags used can be the station name, or a completely separate name of your choosing.

Once you have tuned to a radio station, it is possible to store a name in a directory by using the **Radio store name** command. The system responds with >Name please<. You say the name that you have chosen (e.g. Radio 1).

The system will read out a list of current nametags when given the command **Radio directory**.

**Radio tune <nametag>** is used to select a station that has been previously stored.

## Storing radio stations via voice command

Once you have tuned to a radio station, it is possible to store that station for future use as a pre-set. The following commands apply to the currently tuned station.

The command **Radio store preset <say number (1-9)>** calls up the dialogue for storing a pre-set station.

The command **Radio autostore** enters the autostore function for the selected frequency band (e.g. FM).

| Command                                    | System response                              | Message centre display                      |
|--|--|---|
| "Radio store preset" <preset number (1-9)> | >Radio store preset <preset number (1-9)><   | <b>STORE PRESET (1-9).</b>                  |
| 1. "Radio store" name<br><br>3. "Name"     | 2. >Radio store name, name please<<br>>Name< | <b>RADIO STORE NAME, NAME PLEASE STORED</b> |
| "Radio autostore"                          | >Radio autostore<                            | <b>RADIO AUTOSTORE</b>                      |
| "Radio tune" <name>                        | >Radio tune <name><                          | <b>RADIO TUNE</b>                           |

# Voice control

## Tune/delete from the radio directory

The commands **Radio play directory** or **Radio directory** prompt the system to read aloud the entire list of nametag entries in the radio directory.

The nametag list is read out in stored order, and commands can be entered during the system response.

### Replay

After a nametag has been read out by the system, give the command **Replay** and the nametag will be repeated.

### Tune

After a nametag has been read out by the system, give the command **Tune** and the radio tunes to the station saved under that nametag.

### Delete

After a nametag has been read out by the system, give the command **Delete** and the nametag will be removed from the directory.

After a nametag has been read out by the system, give the command **Cancel** and the current Voice session will end.

| Command   | System response                                | Message centre display                   |
|---|--|--|
| <b>Radio play directory</b> You can say " <b>Replay</b> ", " <b>Tune</b> ", " <b>Delete</b> " or " <b>Cancel</b> " after each name. | >Radio play directory<<br>Reads out directory. | <b>RADIO DIRECTORY Station frequency</b> |

## Deleting the directory

The command **Radio delete directory** deletes all entries in the radio directory.

| Command                     | System response  | Message centre display                   |
|-----------------------------|--|--|
| 1. "Radio delete directory" | 1. >Radio delete directory, confirm yes or no<                 | 1. <b>DELETE DIRECTORY SAY YES OR NO</b> |
| 2. "Yes"                    | 1. >Are you sure that you want to delete the whole directory?< | 2. <b>SAY YES OR NO</b>                  |
| 3. "Yes"                    | 1. >Directory deleted<   | 3. <b>DIRECTORY DELETED</b>              |

# Voice control

---

## Selecting disc and track numbers

For CD player commands, say disc and track numbers as in the following examples:

- **CD play disc one.**
- **CD play disc six track ten.**
- **CD play track twenty five.**
- **CD play track forty seven.**

| <b>Command</b>  | <b>System response</b>                                      | <b>Message centre display</b>   |
|---|---|---|
| "CD help"   | >List of CD commands<                                       | <b>CD HELP</b>  |
| "CD play"   | >CD play<   | <b>CD PLAY</b>  |
| "CD play disc" <say number (1-6)>                           | >CD play disc <say number (1-6)><                           | <b>DISC &lt;disc number (1-6)&gt;</b>   |
| "CD play next disc"   | >CD play next disc<   | <b>NEXT DISC</b>  |
| "CD play previous disc"                                     | >CD play previous disc<                                     | <b>PREVIOUS DISC</b>  |
| "CD play track" <say number (1-99)>                         | >CD play track <say number (1-99)><                         | <b>TRACK &lt;track number (1-99)&gt;</b>  |
| "CD play disc" <say number (1-6)> track <say number (1-99)> | >CD play disc <say number (1-6)> track <say number (1-99)>< | <b>DISC &lt;disc number (1-6)&gt;</b><br><b>TRACK &lt;track number (1-99)&gt;</b> |

# Voice control

---

## NOTEPAD COMMANDS

### Using Notepad

Notepad allows you to record short messages as memory aids or reminders.

You can record a maximum of 10 notes, each with a maximum duration of 30 seconds.

Briefly pull the voice control (the audio will mute). A tone will be heard, and **LISTENING** will be displayed on the main message centre. A notepad command can now be given.

| Command                             | System response   | Action  |
|-------------------------------------|---|---|
| “Record note” or “Notepad record”   | Notepad gives a beep to indicate the start of recording.  | You may start your recording after the beep. To stop recording, hold the voice recognition control.   |
| “Play notepad” or “Rear notepad”    | Notepad will recite each note in turn. You can say Replay, Delete or Cancel after each beep or remain silent to hear the next note. | Saying Replay will replay the previous message. Saying Delete will delete the previous message. Saying Cancel will cancel the previous message. |
| “Clear notepad” or “Notepad delete” | Do you want to clear the notepad?   | Say Yes to delete all stored notes. Say No to cancel the command.   |
| “Notepad help”                      | The system will recite notepad information and all the commonly used commands   |   |



# Index

## A

|   |     |
|---|-----|
| ABS driving hints . . . . .                                       | 130 |
| ACC . . . . .   | 142 |
| Accessories . . . . .   | 35  |
| Adaptive cruise control . . . . .                                 | 142 |
| Adaptive cruise control (ACC)<br>Principle of operation . . . . . | 141 |
| Adaptive front lighting system (AFS) . . . . .                    | 73  |
| The AFS advantage . . . . .                                       | 73  |
| Adjusting the steering wheel . . . . .                            | 68  |
| Automatic seat movement . . . . .                                 | 68  |
| Steering wheel position memory . . . . .                          | 68  |
| Adjusting the suspension . . . . .                                | 158 |
| Access height . . . . .   | 159 |
| Access height from off-road height . . . . .                      | 159 |
| Additional lift whilst in extended mode . . . . .                 | 161 |
| Automatic height change warnings . . . . .                        | 160 |
| Crawl mode (locked at Access height) . . . . .                    | 159 |
| Door open override . . . . .                                      | 160 |
| Extended mode . . . . .   | 161 |
| Remote operation . . . . .  | 161 |
| Suspension freeze . . . . .                                       | 161 |
| Suspension height indicators . . . . .                            | 158 |
| Adjusting the windshield washer jets . . . . .                    | 91  |
| Front washer jets . . . . .                                       | 91  |
| Rear washer jets . . . . .  | 91  |
| AFS . . . . .   | 73  |
| Air bag labels . . . . .  | 62  |
| Air bag service information . . . . .                             | 63  |
| Air bag warning lamp . . . . .                                    | 62  |
| Air suspension<br>Principle of operation . . . . .                | 157 |
| Air suspension messages . . . . .                                 | 162 |
| Air vents . . . . .   | 103 |
| Intake air . . . . .  | 104 |
| Alarm<br>Principle of operation . . . . .                         | 45  |
| Arming the alarm . . . . .  | 45  |
| Anti-theft alarm indicator . . . . .                              | 45  |
| Partial arming . . . . .  | 45  |
| Perimetric alarm . . . . .  | 45  |
| Audio control . . . . .   | 69  |
| Audio unit commands . . . . .                                     | 308 |
| Starting a dialogue . . . . .                                     | 308 |
| Audio unit overview . . . . .                                     | 243 |

|   |     |
|---|-----|
| Automatic climate control . . . . .               | 104 |
| General notes . . . . .                           | 106 |
| Operation of controls . . . . .                   | 105 |
| Automatic transmission . . . . .                  | 121 |
| CommandShift™ . . . . .                           | 123 |
| Electronically selected automatic modes . . . . . | 123 |
| Kick-down in automatic mode . . . . .             | 122 |
| Messages . . . . .                                | 124 |
| Selector lever positions . . . . .                | 121 |
| Sport mode . . . . .                              | 122 |
| Autostore control . . . . .                       | 251 |
| Auxiliary input (AUX IN) socket . . . . .         | 264 |
| Auxiliary mode . . . . .                          | 265 |
| Auxiliary power sockets . . . . .                 | 111 |
| Rear auxiliary power sockets . . . . .            | 111 |
| <b>B</b>  |     |
| Balance/fade control . . . . .                    | 249 |
| Balance adjustment . . . . .                      | 249 |
| Fader adjustment . . . . .                        | 249 |
| Bass/treble control . . . . .                     | 247 |
| Bass response adjustment . . . . .                | 247 |
| Logic 7 settings . . . . .                        | 248 |
| Resetting tone values . . . . .                   | 249 |
| Source tone memory . . . . .                      | 248 |
| Subwoofer settings . . . . .                      | 247 |
| Treble response adjustment . . . . .              | 247 |
| Battery care . . . . .                            | 194 |
| Check and replenish battery electrolyte . . . . . | 195 |
| Battery charging . . . . .                        | 197 |
| Battery warning symbols . . . . .                 | 194 |
| Bluetooth setup . . . . .                         | 284 |
| Bluetooth operation . . . . .                     | 284 |
| Booster cables . . . . .                          | 195 |
| Brake fluid check . . . . .                       | 188 |
| Checking the fluid level . . . . .                | 188 |
| Topping up the fluid . . . . .                    | 188 |
| Brakes<br>Principle of operation . . . . .        | 128 |
| Breaking in . . . . .                             | 136 |
| Bulb changing . . . . .                           | 77  |
| Bulb specification chart . . . . .                | 87  |

# Index

## C

- Car wash . . . . . 177
- Catalytic converter . . . . . 168
- Centre console . . . . . 113
  - Card holder . . . . . 113
  - CD storage . . . . . 113
- Changing a bulb . . . . . 77
  - Bulb access . . . . . 77
  - Cornering lamp bulb . . . . . 80
  - Courtesy lamp bulb . . . . . 85
  - Door/puddle/footwell lamp bulb . . . . . 85
  - Front fog lamp bulb . . . . . 82
  - Front indicator lamp bulb . . . . . 82
  - Front marker lamp bulb . . . . . 81
  - Front side lamp bulb . . . . . 81
  - Headlamp bulb (Halogen) high beam . . . . . 78
  - Headlamp bulb (Halogen) low beam . . . . . 78
  - Headlamp bulb (Xenon) . . . . . 79
  - Licence plate lamp bulb . . . . . 84
  - Map lamp bulb . . . . . 86
  - Mirror downlighter bulb . . . . . 86
  - Rear lamp bulb . . . . . 84
  - Side repeater lamp bulb . . . . . 85
  - Tailgate lamp bulb . . . . . 85
  - Vanity mirror lamp bulb . . . . . 86
- Changing a fuse . . . . . 225
- Changing a road wheel . . . . . 201
  - Changing a wheel . . . . . 206
  - Raising the vehicle . . . . . 204
  - Spare wheel . . . . . 202
  - Stowing the changed wheel . . . . . 208
  - Tool kit location . . . . . 201
  - Using wheel chocks . . . . . 204
  - Wheel changing safety . . . . . 202
- Changing the vehicle battery . . . . . 198
  - Battery disposal . . . . . 198
  - Battery removal . . . . . 198
  - Battery replacement . . . . . 198
- Changing the wiper blades . . . . . 92
  - Front . . . . . 92
  - Rear . . . . . 92
- Charging the vehicle battery . . . . . 197
  - Battery warning indicator . . . . . 198
  - Disconnecting the battery . . . . . 197
  - Effects of battery disconnection . . . . . 198
  - Reconnecting the battery . . . . . 197
- Checking the wiper blades . . . . . 91
- Child safety locks . . . . . 67
- Child seats . . . . . 64
  - Automatic Locking Reels (ALR) . . . . . 65
  - Child restraint checklist . . . . . 66
  - Child restraints for larger children . . . . . 65
  - Child restraints for small children and babies . . . . . 65
- Cigar lighter . . . . . 111
  - Ashtray . . . . . 111
- Cleaning the exterior . . . . . 177
  - Cleaning after off-road driving . . . . . 177
  - Glass and mirrors . . . . . 178
  - Removing tar spots . . . . . 177
  - Underbody maintenance . . . . . 178
  - Washing the vehicle . . . . . 177
- Cleaning the interior . . . . . 178
  - Air bag module covers . . . . . 179
  - Carpet and fabrics . . . . . 178
  - Instrument pack, clock and audio unit . . . . . 179
  - Leather . . . . . 178
  - Plastic and cloth . . . . . 178
  - Seat belts . . . . . 179
- Clock . . . . . 110
  - Setting the time . . . . . 110
- Coded keys . . . . . 44
- Compact disc function menu . . . . . 259
- Compact disc pause . . . . . 258
- Compact disc playback . . . . . 258
- Compact disc selection . . . . . 257
- Compact disc track scanning . . . . . 261
- Cool box . . . . . 113
- Coolant check . . . . . 186
- Cruise control . . . . . 69, 139
  - Principle of operation . . . . . 139
- Cup holders . . . . . 112
- Curtain air bags . . . . . 60

# Index

## D

- Detachable tow ball . . . . . 174
  - Fitting the tow ball . . . . . 174
  - Removing the tow ball . . . . . 175
- Direction indicators . . . . . 74
- Dynamic response fluid check . . . . . 190
  - Topping up the fluid . . . . . 190

## E

- Economical driving . . . . . 138
  - Driving tips for fuel economy . . . . . 138
  - Maintenance and fuel economy . . . . . 138
- Ejecting compact discs . . . . . 256
- Ejecting multiple compact discs . . . . . 257
- Electric exterior mirrors . . . . . 95
  - Folding the mirror body . . . . . 95
  - Mirror glass adjustment . . . . . 95
  - Reverse mirror dipping . . . . . 96
- Electric parking brake (EPB) . . . . . 131
  - Applying the electric parking brake . . . 131
  - Dynamic operation . . . . . 132
  - Messages . . . . . 133
  - Releasing the electric parking brake . . 132
- Electric seats . . . . . 48
  - Folding armrest . . . . . 49
  - Lumbar support adjustment . . . . . 49
- Electric sunroof . . . . . 107
  - Anti-trap mechanism . . . . . 108
  - Sunroof calibration . . . . . 108
- Electric windows . . . . . 93
  - Anti-trap mechanism (front windows only)  
94
  - One touch operation (front windows only)  
93
  - Operating the windows . . . . . 93
  - Rear window isolation switch . . . . . 94
  - Rear window operation . . . . . 94
- Engine compartment overview . . . . . 183
- Engine coolant check . . . . . 186
  - Checking the coolant level . . . . . 186
  - Topping up the coolant . . . . . 187
- Engine immobiliser . . . . .
  - Principle of operation . . . . . 44

- Engine oil check . . . . . 185
  - Checking the oil level . . . . . 185
  - Engine oil specification . . . . . 186
  - Topping up the oil . . . . . 186
- EPB . . . . . 131
- Essential towing checks . . . . . 173
- Event data recording . . . . . 34

## F

- Fast forward/reverse . . . . . 259
- Fastening the seat belts . . . . . 55
  - Releasing the belt . . . . . 55
- Filling station information . . . . . 30
  - Engine coolant specification . . . . . 31
  - Fuel filler flap . . . . . 30
  - Refuelling . . . . . 30
  - Tire pressures . . . . . 31
- Front fog lamps . . . . . 72
- Fuel cut-off . . . . . 168
  - Resetting the fuel cut-off system . . . . 168
- Fuel filler flap . . . . . 166
- Fuel quality . . . . . 164
  - Octane requirements . . . . . 164
- Fuse box locations . . . . . 224
  - Engine compartment fuse box . . . . . 224
  - Passenger compartment fuse box . . . . 225
- Fuse specification chart . . . . . 226
  - Engine compartment fuse box . . . . . 226
  - Passenger compartment fuse box . . . . 228

## G

- Garage door transceiver . . . . . 116
  - Accessories . . . . . 118
  - Compliance . . . . . 118
  - Erasing channels . . . . . 118
  - Operating the Land Rover HomeLink®
    - Transmitter . . . . . 117
  - Precautions . . . . . 116
  - Programming . . . . . 116
  - Reprogramming a single button . . . . . 118
  - Training a garage door opener
    - equipped with rolling codes . . . . . 117
- Gauges . . . . . 98
  - Fuel gauge . . . . . 98
  - Tachometer . . . . . 98
  - Temperature gauge . . . . . 98

# Index

|   |     |   |     |
|---|-----|---|-----|
| Gear changing . . . . .                       | 172 | Interior lamps . . . . .                  | 74  |
| General driving points . . . . .              | 136 | Front interior lamps . . . . .            | 74  |
| Before driving off-road . . . . .             | 137 | Rear interior lamps . . . . .             | 75  |
| Breakdown safety . . . . .                    | 136 | Interior mirror . . . . .                 | 96  |
| Extreme driving conditions . . . . .          | 137 | <b>J</b>                                  |     |
| Vehicle stability . . . . .                   | 137 | Jump starting . . . . .                   | 195 |
| Wading . . . . .                              | 137 | <b>K</b>                                  |     |
| Warning indicators . . . . .                  | 136 | Keys . . . . .                            | 40  |
| General information on radio                  |     | Keys and remote controls                  |     |
| frequencies . . . . .                         | 40  | Principle of operation . . . . .          | 37  |
| <b>H</b>                                      |     | <b>L</b>                                  |     |
| Hazard warning flashers . . . . .             | 72  | Lashing points . . . . .                  | 233 |
| HDC . . . . .                                 | 149 | LATCH anchor points . . . . .             | 66  |
| Head restraints . . . . .                     | 50  | Tether strap anchorages . . . . .         | 67  |
| Front head restraints . . . . .               | 50  | Levelling . . . . .                       | 172 |
| Rear head restraints . . . . .                | 50  | Lighting                                  |     |
| Headlamp washers . . . . .                    | 91  | General information . . . . .             | 70  |
| Headphones . . . . .                          | 263 | Lighting control . . . . .                | 71  |
| Heated seats . . . . .                        | 52  | Automatic control lamps . . . . .         | 72  |
| Heated windows and mirrors . . . . .          | 106 | Headlamp courtesy delay . . . . .         | 71  |
| Exterior mirrors . . . . .                    | 106 | High and low beam headlamps . . . . .     | 71  |
| Hill descent control . . . . .                | 149 | Side lamps . . . . .                      | 71  |
| Hill descent control (HDC)                    |     | Load carrying                             |     |
| Principle of operation . . . . .              | 149 | General information . . . . .             | 169 |
| Hints on driving with ABS . . . . .           | 130 | Loading compact discs . . . . .           | 255 |
| ABS and off-road driving . . . . .            | 130 | Inserting a single disc . . . . .         | 255 |
| ABS warning indicator . . . . .               | 130 | Inserting multiple discs . . . . .        | 255 |
| Cornering Brake Control (CBC) . . . . .       | 131 | Locking and unlocking . . . . .           | 41  |
| Electronic Brake Distribution (EBD) . . . . . | 131 | Automatic re-lock . . . . .               | 42  |
| Emergency Brake Assist (EBA) . . . . .        | 131 | Automatic unlocking . . . . .             | 42  |
| Hood lock . . . . .                           | 182 | Interior door handles and door            |     |
| Horn . . . . .                                | 69  | locking levers . . . . .                  | 42  |
| <b>I</b>                                      |     | Locking with the remote control . . . . . | 41  |
| Information messages . . . . .                | 101 | Master lock and unlock switches . . . . . | 42  |
| Critical warning messages . . . . .           | 101 | Opening the tailgate . . . . .            | 43  |
| Gear selector display . . . . .               | 102 | Partial locking . . . . .                 | 42  |
| Information messages . . . . .                | 101 | Speed-related locking . . . . .           | 42  |
| Languages . . . . .                           | 101 | Superlocking . . . . .                    | 41  |
| Odometer display . . . . .                    | 102 | Tailglass . . . . .                       | 43  |
| Service interval indicator . . . . .          | 102 | Luggage anchor points . . . . .           | 169 |
| Warnings messages . . . . .                   | 101 | Luggage covers . . . . .                  | 169 |
| Instrument lighting dimmer . . . . .          | 109 | Operating the luggage cover . . . . .     | 170 |
| Instrument panel overview . . . . .           | 97  | Removal of the deployed luggage           |     |
|   |     | cover . . . . .                           | 170 |

# Index

## M

|  |     |
|--|-----|
| Maintenance                                |     |
| General information . . . . .              | 180 |
| Technical specifications . . . . .         | 192 |
| Memory function . . . . .                  | 115 |
| Lazy entry . . . . .                       | 115 |
| Recalling a stored seat position . . . . . | 115 |
| Setting a memory pre-set . . . . .         | 115 |
| Menu functions . . . . .                   | 275 |
| Accessing a locked channel . . . . .       | 278 |
| Category search . . . . .                  | 275 |
| Changing the parental lock PIN . . . . .   | 279 |
| Hiding/showing a channel . . . . .         | 276 |
| Locking or unlocking a channel . . . . .   | 277 |
| Parental lock . . . . .                    | 277 |
| Unlocking all locked channels . . . . .    | 278 |
| Mirrors . . . . .                          | 106 |
| MP3 file playback . . . . .                | 261 |

## N

|                            |     |
|----------------------------|-----|
| Notepad commands . . . . . | 312 |
| Using Notepad . . . . .    | 312 |

## O

|  |     |
|--|-----|
| Occupant sensing . . . . .                   | 61  |
| Passenger air bag status indicator . . . . . | 61  |
| Oil check . . . . .                          | 185 |
| On/off control . . . . .                     | 244 |
| Opening and closing the hood . . . . .       | 182 |
| Closing the hood . . . . .                   | 182 |
| Opening the hood . . . . .                   | 182 |

## P

|                                      |     |
|--------------------------------------|-----|
| Panic alarm . . . . .                | 46  |
| Parking aid . . . . .                | 134 |
| Principle of operation . . . . .     | 134 |
| Personalised settings . . . . .      | 100 |
| Phonebook . . . . .                  | 295 |
| Phone book . . . . .                 | 295 |
| Power steering fluid check . . . . . | 189 |
| Checking the fluid level . . . . .   | 189 |
| Topping up the fluid . . . . .       | 189 |

## Principle of operation

|  |        |
|--|--------|
| Access height . . . . .                  | 157    |
| Compliance . . . . .                     | 37, 44 |
| Crawl mode . . . . .                     | 157    |
| Extended mode . . . . .                  | 157    |
| Foot brake . . . . .                     | 128    |
| High speed height . . . . .              | 157    |
| How the air bag SRS works . . . . .      | 58     |
| Knee bolsters . . . . .                  | 60     |
| Messages . . . . .                       | 129    |
| Off-road height . . . . .                | 157    |
| Operation . . . . .                      | 157    |
| Remote control battery . . . . .         | 37     |
| Suspension warning indicator . . . . .   | 158    |
| Priority programme type (PTY) . . . . .  | 253    |
| PTY programme type . . . . .             | 253    |
| PTY search . . . . .                     | 253    |
| Programming the remote control . . . . . | 38     |
| Air suspension control . . . . .         | 38     |
| Headlamp courtesy delay . . . . .        | 38     |
| Panic alarm . . . . .                    | 38     |
| Single-point entry . . . . .             | 39     |
| Tailgate release . . . . .               | 39     |
| Tailglass release . . . . .              | 39     |

# Index

## Q

|   |    |
|---|----|
| Quick start . . . . .   | 7  |
| Air suspension . . . . .                                      | 23 |
| Audio systems . . . . .                                       | 26 |
| Automatic transmission . . . . .                              | 21 |
| CD operation . . . . .  | 27 |
| Central locking . . . . .                                     | 8  |
| Child seats . . . . .   | 12 |
| CommandShift™ . . . . .                                       | 22 |
| Cruise control . . . . .                                      | 25 |
| Direction/turn indicators and<br>Headlamp high beam . . . . . | 20 |
| Door mirror adjustment . . . . .                              | 11 |
| Driver's power operated seat<br>adjustment . . . . .          | 9  |
| Driving position memory (when fitted) . . . . .               | 10 |
| Electric Parking Brake (EPB) . . . . .                        | 21 |
| Exterior lamps master switch . . . . .                        | 20 |
| Facia . . . . .   | 16 |
| Heating and ventilation . . . . .                             | 14 |
| Hill Descent Control (HDC) . . . . .                          | 23 |
| Hood . . . . .  | 9  |
| Instrument pack . . . . .                                     | 18 |
| Parking aid . . . . .   | 25 |
| Passenger airbag deactivation . . . . .                       | 13 |
| Power fold mirrors . . . . .                                  | 11 |
| Remote control . . . . .                                      | 7  |
| Reverse automatic mirror dip . . . . .                        | 11 |
| Seat belts and child restraints . . . . .                     | 12 |
| Steering column adjustment . . . . .                          | 11 |
| Steering column levers . . . . .                              | 19 |
| Sunroof . . . . .   | 12 |
| Tailgate . . . . .  | 8  |
| Telephone - Bluetooth system . . . . .                        | 28 |
| Terrain response system . . . . .                             | 24 |
| Transfer gearbox . . . . .                                    | 22 |
| Warning indicators (attention) . . . . .                      | 18 |
| Warning indicators (information) . . . . .                    | 19 |
| Windows and door mirrors . . . . .                            | 10 |

## R

|  |     |
|--|-----|
| Radio broadcast data system (RBDS) . . . . .           | 252 |
| RBDS functionality . . . . .                           | 252 |
| Selecting RBDS . . . . .                               | 252 |
| Radio controls . . . . .                               | 267 |
| Radio display . . . . .                                | 268 |
| Extended display screens . . . . .                     | 269 |
| Radio reception . . . . .                              | 242 |
| Rain sensor . . . . .                                  | 89  |
| Rain sensor variable delay . . . . .                   | 89  |
| Rear fog lamps . . . . .                               | 72  |
| Rear seat controls . . . . .                           | 262 |
| Rear seats . . . . .                                   | 51  |
| Rear seats . . . . .                                   | 51  |
| Rear window wiper and washers . . . . .                | 90  |
| Reverse gear input . . . . .                           | 90  |
| Tailgate open disable . . . . .                        | 90  |
| Washer . . . . .                                       | 90  |
| Wiper - continuous operation . . . . .                 | 90  |
| Wiper - intermittent operation . . . . .               | 90  |
| Receiving radio broadcasts . . . . .                   | 270 |
| Direct channel entry . . . . .                         | 273 |
| Recalling a preset channel . . . . .                   | 273 |
| Selecting a category . . . . .                         | 271 |
| Selecting a channel . . . . .                          | 270 |
| Selecting a channel within a set<br>category . . . . . | 271 |
| Signal availability . . . . .                          | 274 |
| Storing channels as presets . . . . .                  | 273 |
| Unsubscribed channels . . . . .                        | 274 |
| Recommended towing weights . . . . .                   | 176 |
| Reduced engine performance . . . . .                   | 138 |
| Check engine . . . . .                                 | 138 |
| Refuelling . . . . .                                   | 167 |
| Remote control programming . . . . .                   | 38  |
| Removing a headlamp . . . . .                          | 75  |
| Refitting the grille . . . . .                         | 76  |
| Refitting the headlamp unit . . . . .                  | 76  |
| Removing the grille . . . . .                          | 75  |
| Removing the headlamp unit . . . . .                   | 75  |
| Removing a rear lamp . . . . .                         | 76  |
| Refitting the rear lamp unit . . . . .                 | 77  |
| Removing the rear lamp unit . . . . .                  | 76  |
| Repairing minor paint damage . . . . .                 | 179 |
| Repeat compact disc tracks . . . . .                   | 260 |

# Index

|  |     |   |     |
|--|-----|---|-----|
| Running out of fuel . . . . .                  | 166 | Telephone controls . . . . .                  | 282 |
| <b>S</b>                                       |     | Phone display - Facia . . . . .               | 284 |
| Safety . . . . .                               | 33  | Telephone controls - Facia . . . . .          | 282 |
| Safety precautions . . . . .                   | 164 | Telephone controls - Steering wheel . . . . . | 283 |
| Satellite radio                                |     | Telephone setup . . . . .                     | 285 |
| General information . . . . .                  | 266 | Entering the phone PIN . . . . .              | 286 |
| Seat belt height adjustment . . . . .          | 55  | Selecting telephone mode . . . . .            | 285 |
| Seat belt reminder . . . . .                   | 55  | Signal strength . . . . .                     | 287 |
| Seat belts                                     |     | Turning the phone on/off . . . . .            | 286 |
| General information . . . . .                  | 53  | Using display menus . . . . .                 | 285 |
| Shuffle/random . . . . .                       | 260 | Telephone voice control . . . . .             | 296 |
| Side air bags . . . . .                        | 60  | Correcting/Deleting and Cancelling            |     |
| Sitting in the correct position . . . . .      | 47  | inputs . . . . .                              | 301 |
| Snow chains . . . . .                          | 222 | Deleting/Clearing the entire phone            |     |
| Stability control . . . . .                    | 147 | book . . . . .                                | 304 |
| Principle of operation . . . . .               | 147 | Dialling a phone number . . . . .             | 300 |
| Starter switch . . . . .                       | 119 | Dialling/Editing and Deleting from            |     |
| Starting the engine . . . . .                  | 120 | the phone book . . . . .                      | 303 |
| Driving . . . . .                              | 120 | General commands . . . . .                    | 299 |
| General information . . . . .                  | 119 | Storing a telephone name/number . . . . .     | 302 |
| Warming-up . . . . .                           | 120 | Telephone voice control . . . . .             | 296 |
| Station preset buttons . . . . .               | 250 | Using the voice control phone book . . . . .  | 302 |
| Steering wheel lock . . . . .                  | 119 | Terrain response . . . . .                    | 152 |
| Storage compartments . . . . .                 | 114 | Principle of operation . . . . .              | 152 |
| Subscription . . . . .                         | 268 | Tire care . . . . .                           | 209 |
| Sun blinds . . . . .                           | 109 | Age degradation . . . . .                     | 211 |
| Sun visors . . . . .                           | 109 | Checking tire pressures . . . . .             | 210 |
| Sunroof . . . . .                              | 107 | Directional tires . . . . .                   | 213 |
| Supplementary restraints system                |     | High performance wheel and tire               |     |
| Principle of operation . . . . .               | 57  | combinations . . . . .                        | 213 |
| Switching off the alarm . . . . .              | 46  | Long term storage . . . . .                   | 213 |
| <b>T</b>                                       |     | Pressure compensation for ambient             |     |
| Technical specifications                       |     | temperature changes . . . . .                 | 214 |
| Capacities . . . . .                           | 193 | Punctured tires . . . . .                     | 211 |
| Dimensions . . . . .                           | 238 | Replacement tyres . . . . .                   | 212 |
| Lubricants and fluids . . . . .                | 192 | Tire pressures . . . . .                      | 209 |
| Technical specifications . . . . .             | 236 | Tire wear . . . . .                           | 211 |
| V8 Gasoline Naturally aspirated (NA) . . . . . | 236 | Valves . . . . .                              | 211 |
| V8 Gasoline Supercharged (SC) . . . . .        | 236 | Tire glossary . . . . .                       | 223 |
| Weights . . . . .                              | 237 | Terms used . . . . .                          | 223 |
| Telephone . . . . .                            | 288 | Tire grading . . . . .                        | 217 |
| General information . . . . .                  | 280 |   |     |

# Index

|   |     |
|---|-----|
| Tire information labels . . . . .                   | 214 |
| Steps for determining correct load limit . . . . .  | 216 |
| Tire pressure label/placard (Canada only) . . . . . | 214 |
| Tire pressure label/placard (USA only) . . . . .    | 215 |
| Tire pressure monitoring system (TPMS) . . . . .    | 218 |
| Messages . . . . .                                  | 221 |
| TPMS operation . . . . .                            | 218 |
| Tow ball stowage . . . . .                          | 173 |
| Towing a trailer . . . . .                          | 171 |
| Points to remember . . . . .                        | 171 |
| Tongue weight . . . . .                             | 172 |
| Trailer hitch . . . . .                             | 172 |
| Vehicle weights . . . . .                           | 172 |
| Towing points . . . . .                             | 231 |
| Front towing point . . . . .                        | 231 |
| Rear towing point . . . . .                         | 232 |
| Towing the vehicle on four wheels . . . . .         | 234 |
| After towing on four wheels . . . . .               | 234 |
| TPMS . . . . .                                      | 218 |
| Track selection . . . . .                           | 258 |
| Traction control . . . . .                          |     |
| Principle of operation . . . . .                    | 148 |
| Transfer gearbox . . . . .                          | 125 |
| HIGH range (Hi) . . . . .                           | 125 |
| LOW range (Lo) . . . . .                            | 125 |
| Messages . . . . .                                  | 127 |
| Range changing . . . . .                            | 125 |
| Range changing on the move . . . . .                | 126 |
| Stationary range changing . . . . .                 | 126 |
| Transporting the vehicle . . . . .                  | 234 |
| Trip computer . . . . .                             | 99  |
| Type approvals . . . . .                            | 240 |
| Declaration of conformity . . . . .                 | 240 |

## U

|  |     |
|--|-----|
| Under hood covers . . . . .                    | 185 |
| Fitting . . . . .                              | 185 |
| Removal . . . . .                              | 185 |
| Using ACC . . . . .                            | 142 |
| ACC automatic switch off . . . . .             | 144 |
| ACC failure . . . . .                          | 146 |
| Adjusting the gap . . . . .                    | 144 |
| Adjusting the set speed . . . . .              | 144 |
| Detection limitations . . . . .                | 146 |
| Driving with ACC active . . . . .              | 145 |
| Forward alert . . . . .                        | 145 |
| Low speed automatic switch off . . . . .       | 143 |
| Overriding the set speed/follow mode . . . . . | 143 |
| Resuming the set speed/follow mode . . . . .   | 145 |
| Using booster cables . . . . .                 | 195 |
| Boosting from another vehicle . . . . .        | 195 |
| Boosting procedure . . . . .                   | 196 |
| Using cruise control . . . . .                 | 139 |
| Increasing cruising speed . . . . .            | 140 |
| Reducing cruising speed . . . . .              | 140 |
| Suspending cruise control . . . . .            | 140 |
| Using HDC . . . . .                            | 149 |
| Hill Descent Control (HDC) faults . . . . .    | 150 |
| Hill Descent Control in action . . . . .       | 150 |
| Messages . . . . .                             | 151 |
| Using seat belts during pregnancy . . . . .    | 56  |
| Using snow chains . . . . .                    | 222 |
| Using stability control . . . . .              | 147 |
| Deactivating DSC . . . . .                     | 147 |
| Reactivating DSC . . . . .                     | 147 |
| Using terrain response . . . . .               | 152 |
| Driver override options . . . . .              | 154 |
| General . . . . .                              | 153 |
| Grass-Gravel-Snow . . . . .                    | 153 |
| Inappropriate program selection . . . . .      | 154 |
| Increased suspension height . . . . .          | 154 |
| Messages . . . . .                             | 155 |
| Mud-Ruts . . . . .                             | 153 |
| Rock Crawl . . . . .                           | 153 |
| Sand . . . . .                                 | 153 |
| Wading . . . . .                               | 154 |
| Using the key . . . . .                        | 40  |
| Emergency locking and unlocking . . . . .      | 40  |



# Index

---

|  |     |
|--|-----|
| Using the parking aid . . . . .                | 134 |
| Front parking aid - manual operation . . . . . | 135 |
| System fault . . . . .                         | 135 |
| Towing . . . . .                               | 135 |
| Using the telephone . . . . .                  | 288 |
| Answering/Rejecting calls . . . . .            | 290 |
| Dialling . . . . .                             | 288 |
| Multiple connections . . . . .                 | 292 |
| Scratchpad . . . . .                           | 291 |
| Using the call register . . . . .              | 289 |
| Using voice control . . . . .                  | 305 |
| Defined voice commands . . . . .               | 306 |
| Voice language . . . . .                       | 307 |
| Voice settings . . . . .                       | 306 |
| Using winter tires . . . . .                   | 222 |
| Approved winter tires . . . . .                | 222 |
| <b>V</b>                                       |     |
| Vehicle identification number (VIN) . . . . .  | 235 |
| Federal VIN plate . . . . .                    | 235 |
| Vents . . . . .                                | 103 |
| VIN . . . . .                                  | 235 |
| Voice control . . . . .                        | 69  |
| Activating the voice control system . . . . .  | 69  |
| Principle of operation . . . . .               | 305 |
| Volume control . . . . .                       | 244 |
| Automatic Volume control (AVC) . . . . .       | 244 |
| Information volume offset . . . . .            | 245 |
| Navigation volume offset . . . . .             | 245 |
| Phone volume . . . . .                         | 245 |
| Reset volume settings . . . . .                | 246 |
| Voice volume . . . . .                         | 246 |
| <b>W</b>                                       |     |
| Washer fluid check . . . . .                   | 191 |
| Washing . . . . .                              | 177 |
| Waveband button . . . . .                      | 250 |
| Wheels and tires                               |     |
| General information . . . . .                  | 199 |
| Windshield washers . . . . .                   | 90  |
| Windshield wipers . . . . .                    | 88  |
| Intermittent variable delay . . . . .          | 88  |
| Speed dependent intermittent mode . . . . .    | 89  |
| Speed dependent mode . . . . .                 | 89  |
| Winter tires . . . . .                         | 222 |